

Back Table Tips

PROXIMATE® Reloadable Staplers (TL/TLH/TLV)

Note: Do not remove staple retaining cap from staged reloads until ready to install. This prevents the possibility of nuisance lock-outs and firing issues due to mixing of used and unused reloads.

Pre-Loaded Instrument

Pre-loaded instrument (out-of-box) and staged reloads with staple retaining caps on.



Pre-loaded instrument (out-of-box) and staged reloads with staple retaining caps removed.



Caps should remain on until ready to reload.

Pre-Loaded Instrument Reload Check

Proper pre-loaded reload.

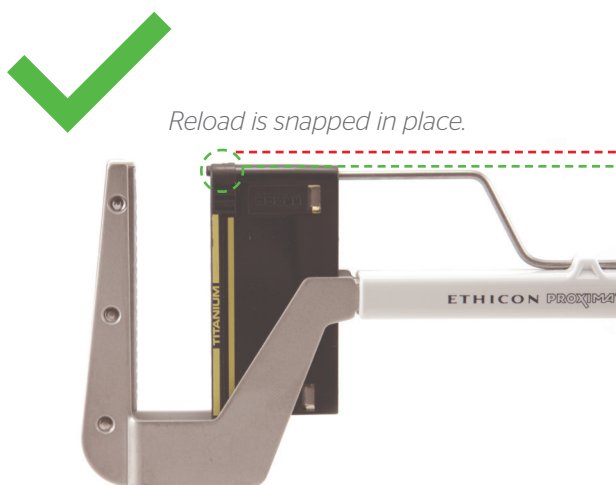

Reload is snapped in place.

Improperly pre-loaded reload.

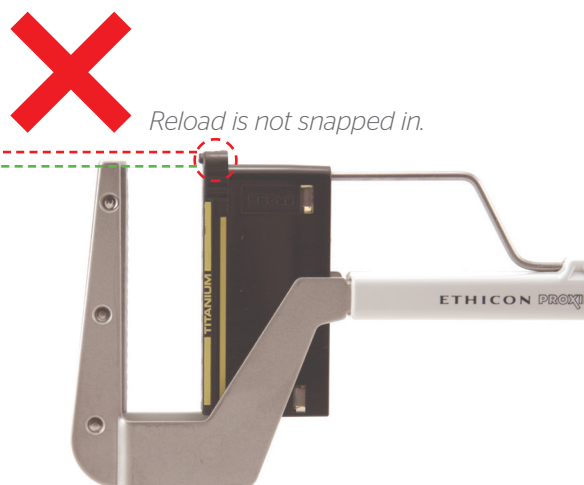

Reload is not snapped in.

Post Firing Reload Removal and Cleaning

Proper reload removal.

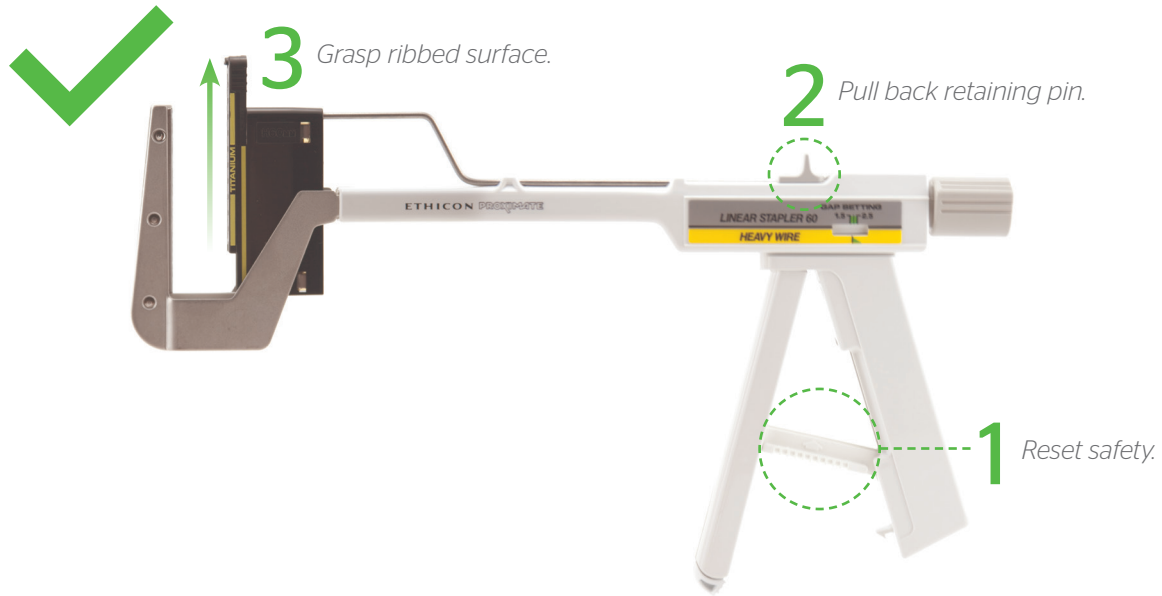

Proper swishing method.

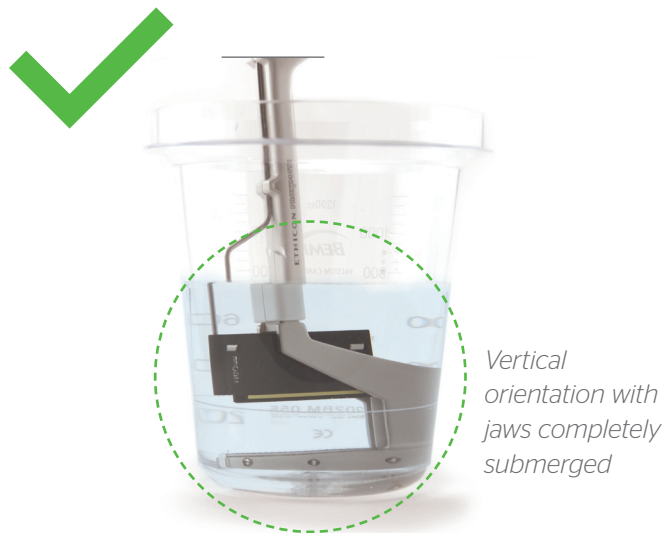

Proper anvil wiping.



Re-Loading Instrument Steps and Checks

Make sure safety is on and retaining pin is back.



Proper staple retaining cap removal.

Slide the reload out sideways.

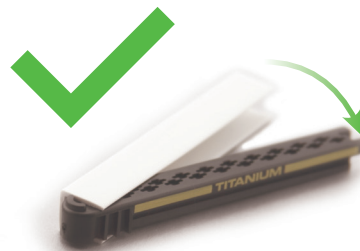

Improper staple retaining cap removal.

DO NOT slide reload downward.

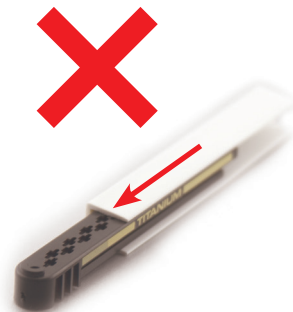

Proper reload placement into channel.

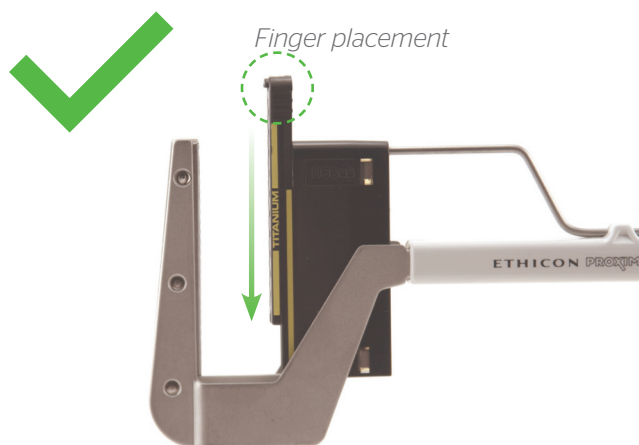

Proper pre-installed reload.

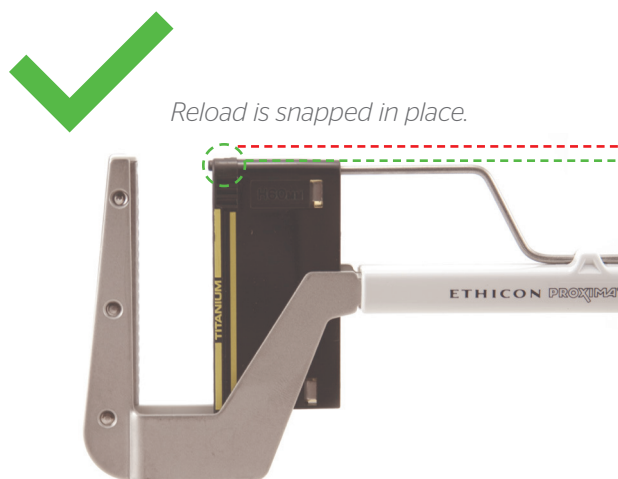

Improperly pre-installed reload.

